

MJ-906 USER MANUAL

ACCESSORY/STRUCTURE

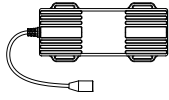

MJ-906



Battery pack

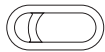

Silicon straps



Nylon straps



Tail light



Wireless remote switch



3 way connector



AC adapter

HOW TO INSTALL

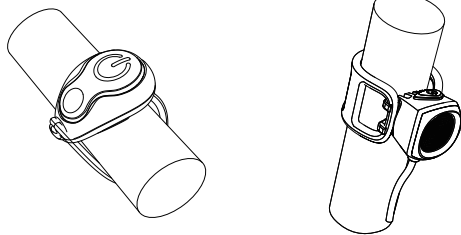
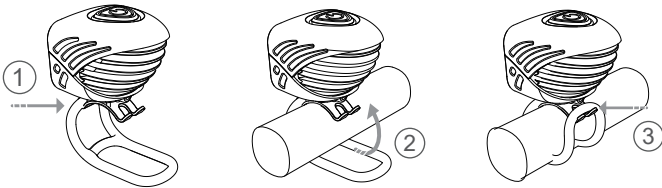

HOW TO INSTALL BATTERY PACK

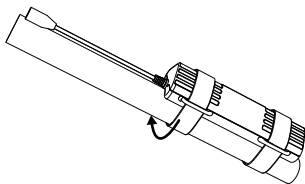

BATTERY INDICATOR



ORANGE
≤30%



HOW TO RECHARGE

RED
Charging

GREEN
Fully charged

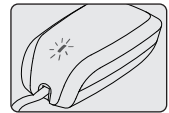

Standard charging time
Approx.4hrs (8.4V 1.8A)

SWITCHING THE LIGHTING MODE

Click power button to turn on, hold 0.5s to turn off

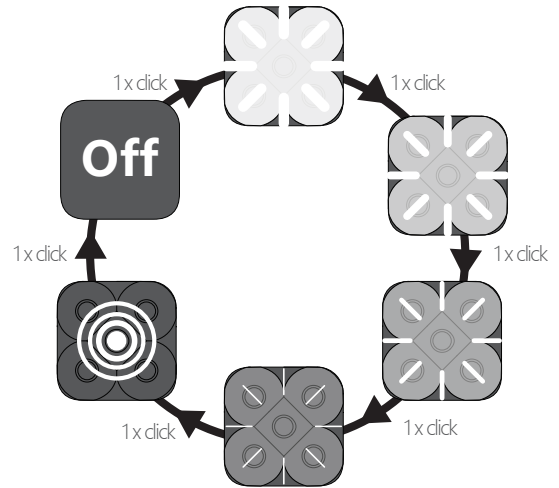

LUMENS/RUN TIME

MODE	100%	75%	50%	20%	FLASH
LUMENS	3200	2300	1500	760	0-1600
h:min	02:10	03:30	05:30	10:30	07:10

HOW TO PAIR THE REMOTE

1. Press and hold both switches for a few seconds till they blink faintly.
2. Quickly connect battery pack to the light head and press the front light switch.
3. Quick flashes indicate successful pairing.
4. Replicate the process for taillight pairing.

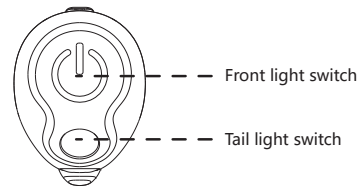

WARNING



EN WARRANTY

The Magicshine lighting system is warrantied for 24 months from the date of purchase.

If you register the lighting system on the Magicshine website you will receive a bonus 6 month warranty.

Battery packs and AC adapters have a 6 month warranty, however, there is no bonus warranty available.

The warranty is limited to defects in material and workmanship on the lighting system itself, the battery pack and the AC adapter.

The warranty is only valid if the affected parts have not been tampered with and there is no intentional damage. Please keep your proof of purchase in a safe place. Proof of purchase must be presented in the event of any claim. Please contact the specialist retailer from whom you purchased the device for complaint or warranty claim.

Alternatively, you can send your complaint or claim directly to Magicshine at

Tel: (+86) 755-295 536 69

Fax: (+86)755-275 897 77

E-mail: support@magicshine.com (order from Magicshine.com online store)

service@magicshine.com (order from other sales channels)

In the event of a justified warranty claim and delivery of a replacement device, you will only be entitled to a model available when replacing.

The manufacturer retains the right to make technical modifications.

ANSI FL 1 STANDARD

