

## MJ-900 USER MANUAL

### ACCESSORY/STRUCTURE

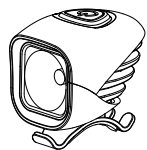

MJ-900



Silicon straps



Nylon straps

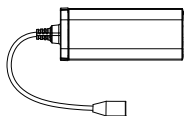

Battery pack

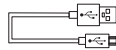

Micro USB Cable

### HOW TO INSTALL

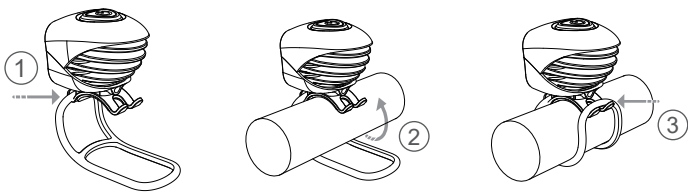

### HOW TO INSTALL BATTERY PACK

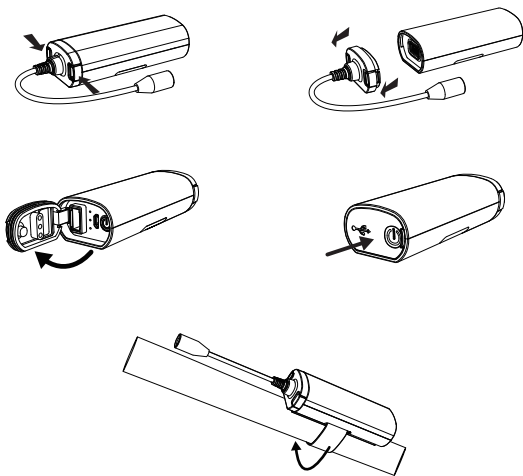

### BATTERY INDICATOR



ORANGE  
≤30%



### HOW TO RECHARGE

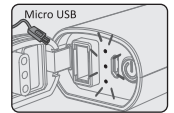
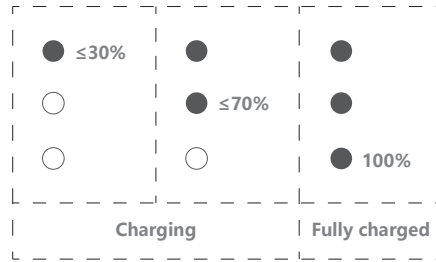

Standard charging time  
Approx. 4hrs (5V 2A)

### SWITCHING THE LIGHTING MODE

Click power button to turn on, hold 0.5s to turn off

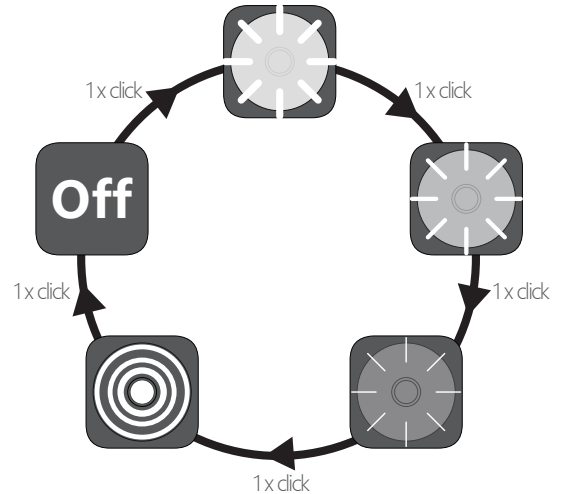

### LUMENS/RUN TIME

MODE	HIGH	MID	LOW	FLASH
LUMENS	1200	470	265	0-870
h:min	02:35	04:30	10:30	04:45

### OPTIONAL PARTS



Magic strap



Tail light



3 way connector

### ⚠ WARNING



## **EN WARRANTY**

---

The Magicshine lighting system is warrantied for 24 months from the date of purchase.

If you register the lighting system on the Magicshine website you will receive a bonus 6 month warranty.

Battery packs and AC adapters have a 6 month warranty, however, there is no bonus warranty available.

The warranty is limited to defects in material and workmanship on the lighting system itself, the battery pack and the AC adapter.

The warranty is only valid if the affected parts have not been tampered with and there is no intentional damage. Please keep your proof of purchase in a safe place. Proof of purchase must be presented in the event of any claim. Please contact the specialist retailer from whom you purchased the device for complaint or warranty claim.

Alternatively, you can send your complaint or claim directly to Magicshine at

Tel: (+86) 755-295 536 69

Fax: (+86)755-275 897 77

**E-mail: [support@magicshine.com](mailto:support@magicshine.com) (order from [Magicshine.com](http://Magicshine.com) online store)**

**[service@magicshine.com](mailto:service@magicshine.com) (order from other sales channels)**

In the event of a justified warranty claim and delivery of a replacement device, you will only be entitled to a model available when replacing.

The manufacturer retains the right to make technical modifications.

### **ANSI FL 1 STANDARD**

