

MJ-902S E-BIKE USER MANUAL

ACCESSORY/STRUCTURE

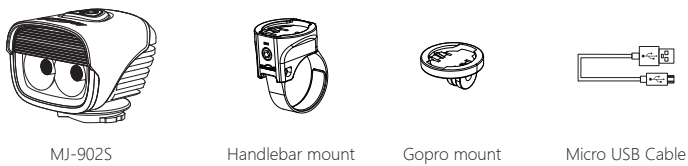

MJ-902S

Handlebar mount

Gopro mount

Micro USB Cable

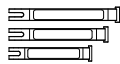

Aero bar compatible strap



Nylon strap



3mm Hex

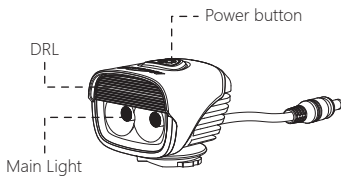

DRL

Main Light

Power button

HOW TO INSTALL

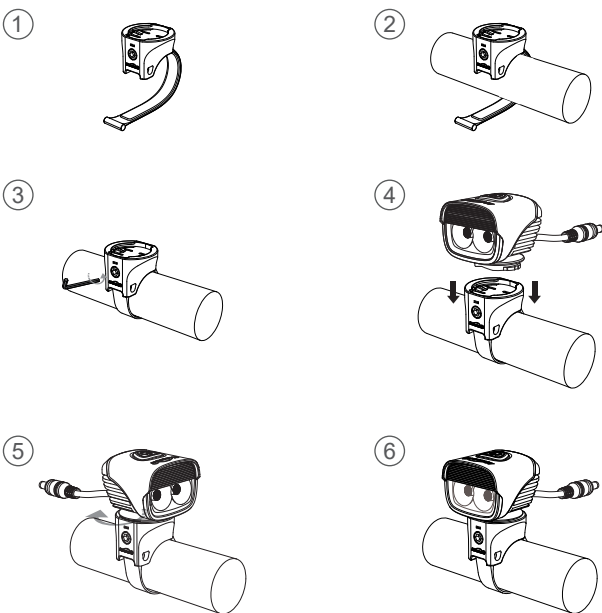

HOW TO CONNECT WITH E-BIKE MOTOR



Connect MJ 902S with YAMAHA



Connect MJ 902S with SHIMANO

*Here are a few tutorial videos for your reference. For other motor-specific questions and more specific inquiries, we suggest contacting your local retailer or bike shop for assistance with troubleshooting and completing the installation.

BATTERY INDICATOR



FLASH RED
0%-10%



RED
11%-30%



SWITCHING THE LIGHTING MODE

Hold 1s power button to turn on/off

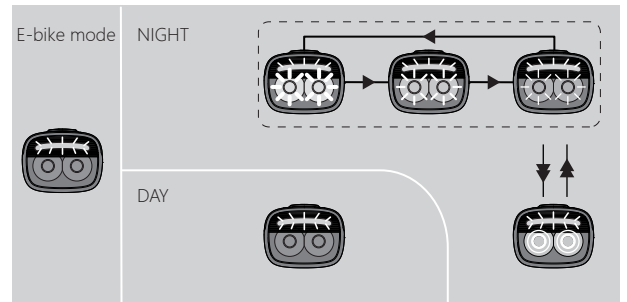

▶ Click

▶▶ Double clicks

⌚ 1s Hold 1 second

LUMENS/RUN TIME

E-bike mode

	NIGHT	HIGH	MID	LOW	FLASH
LUMENS		3000	1500	1000	0-1000
DAY		DRL	/	/	/
LUMENS		25	/	/	/



The data is tested in laboratory conditions, and the actual performance can change according to the environment.

MOTOR OUTPUT



*Our E-Bike lights are retrofitable for direct power from the bike's battery. Identify your bike's motor model to select the right retrofit cable and light. Note that some motors may limit voltage and power, affecting light brightness. Scan the code for details.

OPTIONAL PARTS

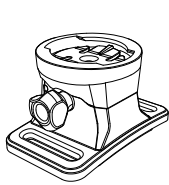

Helmet mount

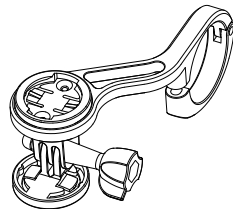

TTA front mount

*Adaptable accessories (sold separately)

⚠ WARNING



EN WARRANTY

The Magicshine lighting system is warranted for 24 months from the date of purchase.

If you register the lighting system on the Magicshine website you will receive a bonus 6 month warranty.

Battery packs and AC adapters have a 6 month warranty, however, there is no bonus warranty available.

The warranty is limited to defects in material and workmanship on the lighting system itself, the battery pack and the AC adapter.

The warranty is only valid if the affected parts have not been tampered with and there is no intentional damage. Please keep your proof of purchase in a safe place. Proof of purchase must be presented in the event of any claim. Please contact the specialist retailer from whom you purchased the device for complaint or warranty claim.

Alternatively, you can send your complaint or claim directly to Magicshine at

Tel: (+86) 755-295 536 69

Fax: (+86)755-275 897 77

E-mail: support@magicshine.com (order from Magicshine.com online store)

service@magicshine.com (order from other sales channels)

In the event of a justified warranty claim and delivery of a replacement device, you will only be entitled to a model available when replacing.

The manufacturer retains the right to make technical modifications.

ANSI FL 1 STANDARD

